

# ***Snap-on Equipment***

**ADJUSTABLE AIR-HYDRAULIC ROLLING JACKBEAM**

**CAPACITY: 7000 LBS.**

**MODEL: JBC217 (for 14K Scissor Lift)**

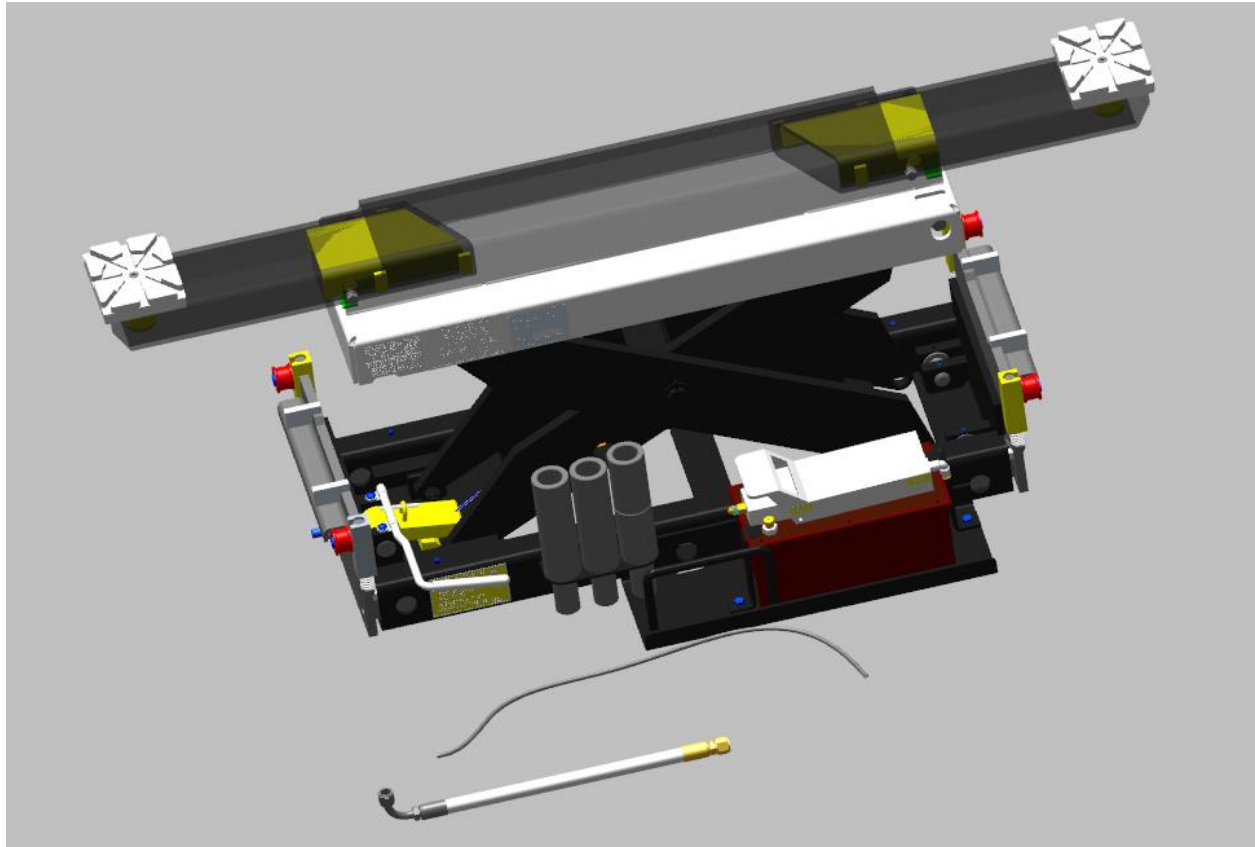

## **INSTALLATION AND OPERATION MANUAL**

**SAVE ALL INSTRUCTIONS  
READ ALL INSTRUCTIONS  
THOROUGHLY BEFORE  
INSTALLING, OPERATING,  
SERVICING, OR MAINTAINING  
THE LIFT.**

***Snap-on Equipment***

309 Exchange Avenue, Conway, AR 72032  
TEL: 800-225-5786

**OCT 2017 REV. B 6-4363**

## OWNER / EMPLOYER OBLIGATIONS

1. The Owner/Employer shall ensure that lift operators are qualified and that they are trained in the safe use and operation of the lift using the manufacturer's operating instructions; ALI/SM 93-1, **ALI Lifting it Right** safety manual; ALI/ST-90 **ALI Safety Tips** card; ANSI/ALI ALOIM-2008, **American National Standard for Automotive Lifts - Safety Requirements for Operation, Inspection and Maintenance**; ALI/WL Series, **ALI Uniform Warning Label Decals/Placards**; and in the case of frame engaging lifts, ALI/LP-GUIDE, **Vehicle Lifting Points/Quick Reference Guide for Frame Engaging Lifts**.
2. The Owner/Employer shall establish procedures to periodically inspect the lift in accordance with the lift manufacturer's instructions or ANSI/ALI ALOIM-2008, **American National Standard for Automotive Lifts - Safety Requirements for Operation, Inspection and Maintenance**; and the Employer shall ensure that the lift inspectors are qualified and that they are adequately trained in the inspection of the lift.
3. The Owner/Employer shall establish procedures to periodically maintain the lift in accordance with the lift manufacturer's instructions or ANSI/ALI ALOIM-2008, **American National Standard for Automotive Lifts - Safety Requirements for Operation, Inspection and Maintenance**; and the Employer shall ensure that the lift maintenance personnel are qualified and that they are adequately trained in the maintenance of the lift.
4. The Owner/Employer shall maintain the periodic inspection and maintenance records recommended by the lift manufacturer's instructions or ANSI/ALI ALOIM-2008, **American National Standard for Automotive Lifts - Safety Requirements for Operation, Inspection and Maintenance**.
5. The Owner/Employer shall display the lift manufacturer's operating instructions; ALI/SM 93-1, **ALI Lifting it Right** safety manual; ALI/ST-90 **ALI Safety Tips** card; ANSI/ALI ALOIM-2008, **American National Standard for Automotive Lifts - Safety Requirements for Operation, Inspection and Maintenance**; ALI/WL Series, **ALI Uniform Warning Label Decals/Placards**; and in the case of frame engaging lifts, ALI/LP-GUIDE, **Vehicle Lifting Points/Quick Reference Guide for Frame Engaging Lifts** in a conspicuous location in the lift area convenient to the operator.
6. The Owner/Operator shall provide necessary lockout/tagout means for energy sources per ANSI Z244.1-1982 (R1993), **Safety Requirements for the Lockout/Tagout of Energy Sources**, before beginning any lift repairs and maintenance.
7. The Owner/Employer shall not modify the lift in any manner without the prior written consent of the manufacturer.

# JACKBEAM INSTALLATION AND OPERATION MANUAL

The Jackbeam should only be used with lifts installed on level concrete floors conforming to the installation instructions for the lift. Consult lift installation instructions for concrete thickness and strength requirements. Ensure clearance around and above lift conforms to installation instructions for the lift.



**ATTENTION!** This lift is intended for indoor installation only. It is prohibited to install this product outdoors. Operating environment temperature range should be 41 – 104 °F (5 – 40 °C). Failure to adhere will result in decertification, loss of warranty, and possible damage to the equipment.

Installation of lifts shall be performed in accordance with ANSO/ALI ALIS, Safety Requirements for Installation and Service of Automotive Lifts

For additional safety instructions regarding lifting, lift types, warning labels, preparing to lift, vehicle spotting, vehicle lifting, maintaining load stability, emergency procedures, vehicle lowering, lift limitations, lift maintenance, good shop practices, installation, operator training and owner/employer responsibilities, please refer to “Lifting It Right” (ALI/SM) and “Safety Tips” (ALI/ST).

For additional instruction on general requirements for lift operation, please refer to “Automotive Lift-Safety Requirements For Operation, Inspection and Maintenance” (ANSI/ALI ALOIM).

+ 070126-Quadra-WLSIA01

## SAFETY INSTRUCTIONS

If attachments, accessories or configuration modifying components that are located in the

load path, affect operation of the lift, affect the lift electrical listing or affect intended vehicle accommodation are used on this lift and, if they are not certified for use on this lift, then the certification of this lift shall become null and void. Contact the participant for information pertaining to certified attachments, accessories or configuration modifying components.

[www.autolift.org](http://www.autolift.org)

©2007 by ALI, Inc.

ALI / WLSIA01

**NOTE: Air supply must be lubricated and include water separator. Failure to do so will damage the air /hydraulic motor and void the manufacturer’s warranty.**

# Table of Contents

1.0	Specifications .....	5
2.0	Shipping Contents .....	6
3.0	Safety Instructions .....	6
4.0	Positioning of Jacking Beam on Lift .....	7
5.0	Raising the Jackbeam .....	8
6.0	Lowering the Jackbeam.....	9
7.0	Storage Position of Jackbeam.....	9
8.0	Positioning of Vehicle on Jackbeam .....	9
9.0	Recommended Maintenance .....	11
10.0	Trouble Shooting .....	12
11.0	Jack Beam Assembly: Exploded View .....	13
12.0	Jack beam Assembly: Parts List .....	14
13.0	Maintenance Schedule .....	16

# 1.0 Specifications

Capacity	<b>7,000 lbs.</b>	<b>3175 kg</b>
Minimum Arm Reach	<b>31"</b>	<b>787 mm</b>
Maximum Arm Reach	<b>53"</b>	<b>1346 mm</b>
Minimum Lowered Height above Deck Surface (no stack pad)	<b>1"</b>	<b>25 mm</b>
Maximum Raised Height above Deck Surface (w/ single pad)	<b>12-3/4"</b>	<b>324 mm</b>
Power Requirements @ 20 in3/min (flow rate)	<b>90-120 psi</b>	<b>6-8 bar</b>
Maximum Operating Pressure @ Rated Load	<b>5210 psi</b>	<b>359 bar</b>
Shipping Weight	<b>329 Lbs.</b>	<b>149 Kg.</b>

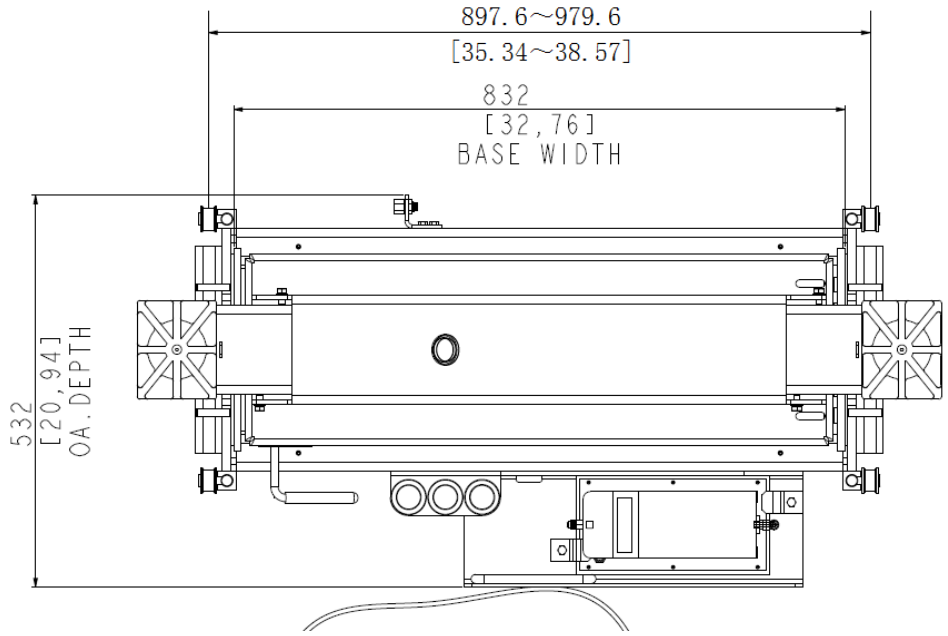

Top View

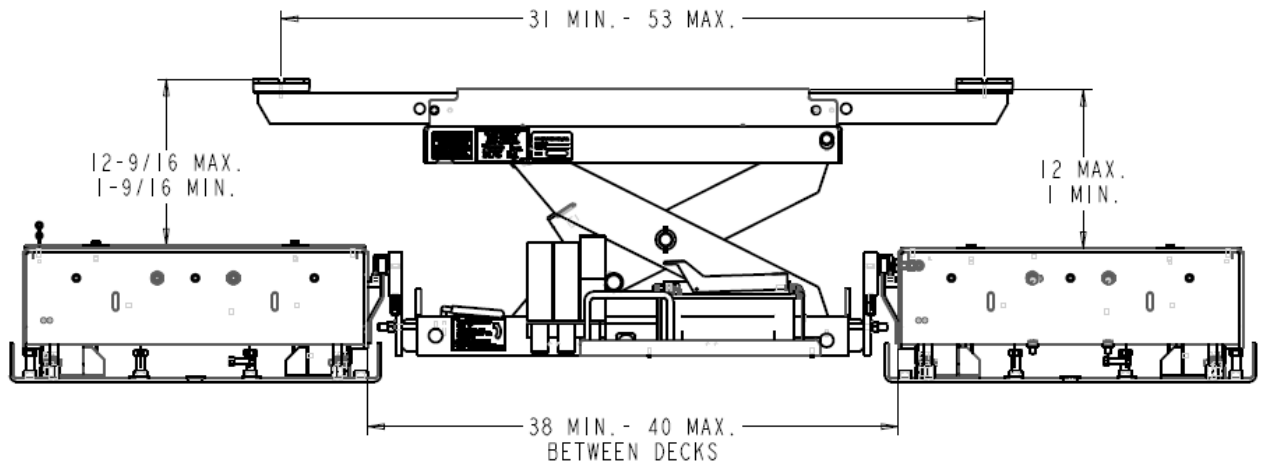

Front View

Figure 1- Jacking beam plan and elevation views

## 2.0 Shipping Contents

The jacking beam is fully assembled and packaged to protect it from any damage that may occur during shipping. Included are the following components:

- Jacking beam assembly, including:
  - Jacking Beam Body
  - Lifting Arms
  - Roller Adapters
  - Air/Hydraulic Pump
- Jacking Beam Keeper Kit
- Stack Pads & Adapters
- Installation & Operation Manual

## 3.0 Safety Instructions

### CAUTION

- Never allow unauthorized or untrained persons to operate the jackbeam.
- Thoroughly train all employees in the use and care of the jackbeam.
- Allow 12" minimum clearance between vehicle and nearest overhead obstruction before raising vehicle above runways. This number is dependent on the number and size of stack adapters used. For each stack adapter, minus the length of each from 12". Failure to comply can result in vehicle damage and/or personal injury.

### WARNING

- To avoid personal injury and/or property damage, the jackbeam must only be operated by trained personnel.
- Never overload the jackbeam. Capacity of jackbeam is stated on nameplate, **DO NOT** exceed.
- Observe and avoid any pinch point areas of the jackbeam.
- Never operate a Jackbeam that is not in proper working order or in a manner not recommended by the vehicle or jacking beam manufacturer.
- Always ensure that the mechanical safety is engaged whenever a vehicle is supported by the Jackbeam.
- Do not use different length stack adapter on each arm. Stack adapter must be used in pairs.
- Load evenly; do not place weight on one side of the jack.

## 4.0 Positioning of Jacking Beam on Lift

**Note:** The Jackbeam must be positioned on the lift correctly prior to usage.

1. Place jackbeams on runway tracks at front and rear of lift with the pump of each facing outwards.
2. Ensure wheels are on the tracks and roll freely.
3. Attach recoil hose to the bulkhead fitting at the rear of each jackbeam, and then other ends to the 'T' fitting on lift.
  - a. The Jackbeam is shipped pre-assembled to install at the front of the lift. The air connection bracket is on the rear left side of the Jackbeam.
  - b. To install the Jackbeam at the rear of the lift, the air connection bracket must be removed and reinstalled on the rear right side. Disconnect the 3/8" polytube, reroute, cut to length and reinstall.

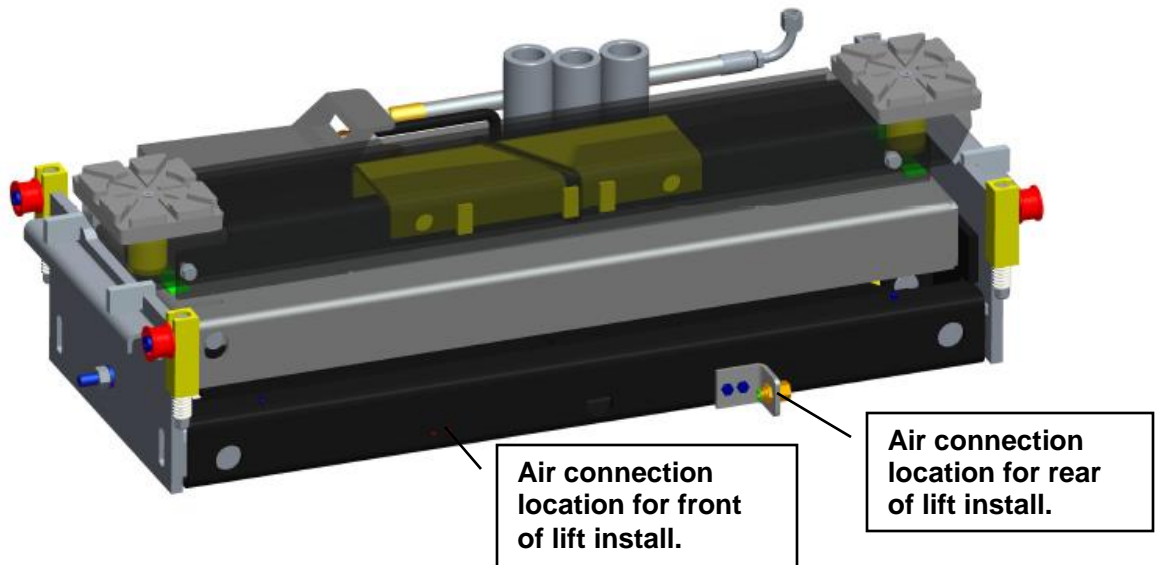

4. Loosen metal knob on the pump by turning counterclockwise before use.



5. Prior to placing vehicle on lift, raise and lower the Jackbeam multiple times and check for air and hydraulic leaks. See sections "[5.0 Raising the Jackbeam](#)" and "[6.0 Lowering the Jackbeam](#)" for operation instructions.

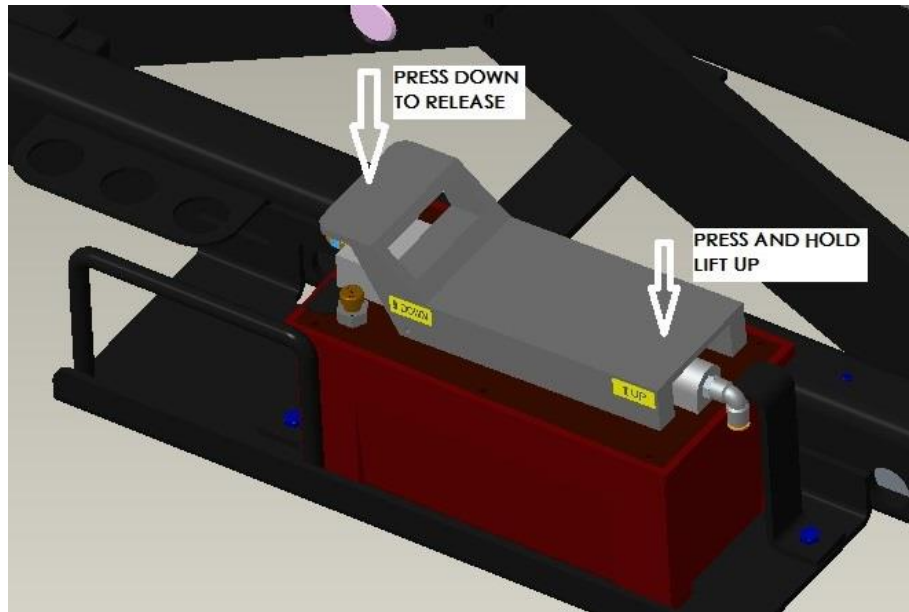

## 5.0 Raising the Jackbeam

1. Prior to placing vehicle on lift, check the operation of the jackbeam.
2. Press the "UP" end on the air/hydraulic pump and hold until jacking beam is at full working height.
3. As lift travels up:
  - Ensure the mechanical safety falls into place at both safety positions.
  - Check system for air and hydraulic leaks.
4. To place a vehicle on the lift, see section "[7.0 Positioning of Vehicle on Jackbeam](#)" for instructions.

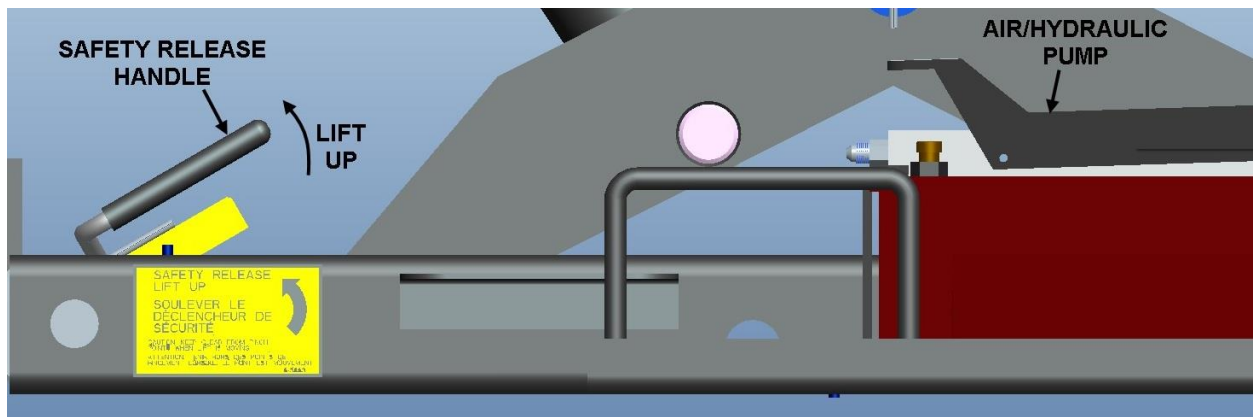



## 6.0 Lowering the Jackbeam

1. To lower the jackbeam, first raise the jackbeam up off the mechanical safety lock.
2. Disengage the safety lock by lifting and holding the Safety Release Handle.
3. Press the "DOWN" handle down on the pump to release pressure allowing the jacking beam to lower to its full down position.
4. Once jackbeam is completely collapsed, release the safety and lowering handles.
5. If lowering from the 2<sup>nd</sup> lock position to the 1<sup>st</sup> lock position, repeat steps 1 to 4. You may release the safety handle once the 2<sup>nd</sup> safety has passed.
6. Lower the Jackbeam onto each safety (Note: there are two safety positions to allow for multiple working heights).

**NOTE:** The Safety Release handle is gravity returned to "reset" the safety.

**After reading these instructions, get familiar with the controls by running the jackbeam through a few cycles before loading vehicle on lift.**

## 7.0 Storage Position of Jackbeam

In order to allow for adequate vehicle drive-on clearance,

1. When not in use, store Jackbeams towards the center of the lift.
2. Ensure lift is fully collapsed.
3. Remove lifting pads if additional clearance is required

## 8.0 Positioning of Vehicle on Jackbeam

The WHEELFREE® jack system has a low profile design, however; may not be suited for all vehicles.

Cautionary steps to consider before driving a vehicle over a rolling jack onto or off of a lift.

- Inspect the underside of the vehicle for low hanging obstructions.
- Inspect the vehicle for points of interference
- Position rear rolling jack beam forward from the rear of the lift.
- Jack pads and extensions must be removed from the jack.
- Make certain the jack is in its fully loader position
- Floor areas must be clear from objects that may be in the path when lowering the lift and/or jack beam
- Air supply must be maintained

## **WARNING**

Lowered standard and/or custom vehicle heights may affect drive over and use of jack or loading of vehicle on lift.

**Failure to follow the cautionary steps as outlined above may result in property damages.**

1. The vehicle must be positioned correctly on the lift prior to raising the vehicle with the Jackbeam. With the vehicle's center of gravity equally spaced between the runways, the Jackbeam can be used to lift the vehicle.
2. Move the Jackbeam to the desired pickup area.
3. Select lifting points that are the same distance from the centerline of the vehicle, i.e. position the Jackbeam pads so that they make contact at the same point on each side of the vehicle.
4. With the Jackbeam positioned, insert the stack pads if not already installed. If additional height is required, use either the short or long stack adapters.

**NOTE:** Use the same length of stack adapter on each lifting arm.

**NOTE:** Lift vehicle at vehicle manufacturer's recommended pickup points only. Please refer to **ALI/LP-GUIDE, Vehicle Lifting Points/Quick Reference Guide for Frame Engaging Lifts.**

5. Extend the arms to the desired pickup point. If required, raise the jackbeam so the arms can be extended above the runways.



**ATTENTION!** Lifting arms should be extended equally as to avoid any off-load of the vehicle that may cause vehicle damage and/or personal injury.

6. As the Jackbeam raises the vehicle, the weight of the Jackbeam is transferred from the rollers to the lift. The roller assemblies on the Jackbeam are spring loaded and are meant to carry the weight of the jack only. When load is applied, the structure cannot be moved.
7. To lower the vehicle, refer back to section "[6.0 Lowering the Jack Beam](#)".



**ATTENTION!** Do not raise lift while vehicle is supported by the Jackbeams. Failure to adhere may cause vehicle damage and/or personal injury.

## 9.0 Recommended Maintenance

### Daily:

1. Inspect that the jackbeam is in proper working condition.
2. Make certain that the automatic engaging safety drops into place when the Jackbeam is raised and that it will release when held in the up position during lowering.
3. Inspect air/hydraulic system for leaks.
4. Inspect for loose bolts, broken/damaged components. Replace as required.
5. Keep the entire Jackbeam as clean as possible at all times.
6. Ensure that the lifting arm stops are working correctly. Fully extend each arm until the stop engages.
7. Inspect condition of rubber lifting pads. Replace if required.

### Monthly:

1. Keep the air source clean and make certain that an air filter is used to keep dirt out of the air motor. To maintain a clean shop air supply, an FRL (oil/lube/filter and regulator) should always be in good working order in conjunction with the use of an oiler/separator.

**NOTE: It is the user(s) responsibility to supply an air filter/lubricator to ensure a clean air source is provided to the air/hydraulic pump. Failure to provide clean air may void manufacturers' warranty. Please contact customer service regarding Optional Kit # 0100.**

2. Check functionality of the rollers, keep clean.
3. Grease upper and lower slider block areas. Use multipurpose, extreme pressure grease such as Megaplex XD%, NGLI grade 2 or equivalent.



**ATTENTION!** Discontinue the use of the Jackbeam immediately if any component(s) are damaged, defective, worn or broken. Please contact Customer Service 1-800-225-5786.

## 10.0 Trouble Shooting

Trouble	Cause	Remedy
Pump runs but lift will not rise after contacting load.	Lift loaded beyond capacity.  Fluid leak at pump, hose or cylinder.  Wrong pump installed on lift.  Pump malfunction.  Pump low on fluid.	Do not exceed capacity of lift list on tag.  Repair leak, refill reservoir.  Verify pressure rating of pump says 5500 psi on label.  Contact customer service to have pump serviced.  Lower jackbeam and check fluid level. Replenish if required.
Pump will not start when "UP" button is pushed.	Insufficient air supply at pump.  Leak in air supply line.  Restriction in air line (i.e. Kink)  Bad air motor.	Pump requires 90 – 120 psi of shop air.  Locate and correct leak.  Locate and correct restriction.  Contact customer service to have pump serviced.
Pump runs but will not lift to full height	Pump low on fluid.	Lower jackbeam and check fluid level. Replenish if required.
Lift does not hold pressure and will slowly descend.	Fluid leak at pump, hose or cylinder.  Lowering valve damaged.  Pump malfunction.	Repair leak, refill reservoir.  Replace damaged or missing parts.  Contact customer service to have pump serviced.
Lift lowers slowly or not at all.	Mechanical Safety is engaged.  Restriction in hydraulic system.	Release mechanical safety.  Contact customer service to have lift serviced.
 <b>WARNING</b>	<b>If jackbeam is in the raised position and will not come down, ensure that the mechanical safety is engaged prior to servicing the lift. Failure to do so can cause vehicle damage and/or personal injury.</b>	

# 11.0 Jack Beam Assembly: Exploded View

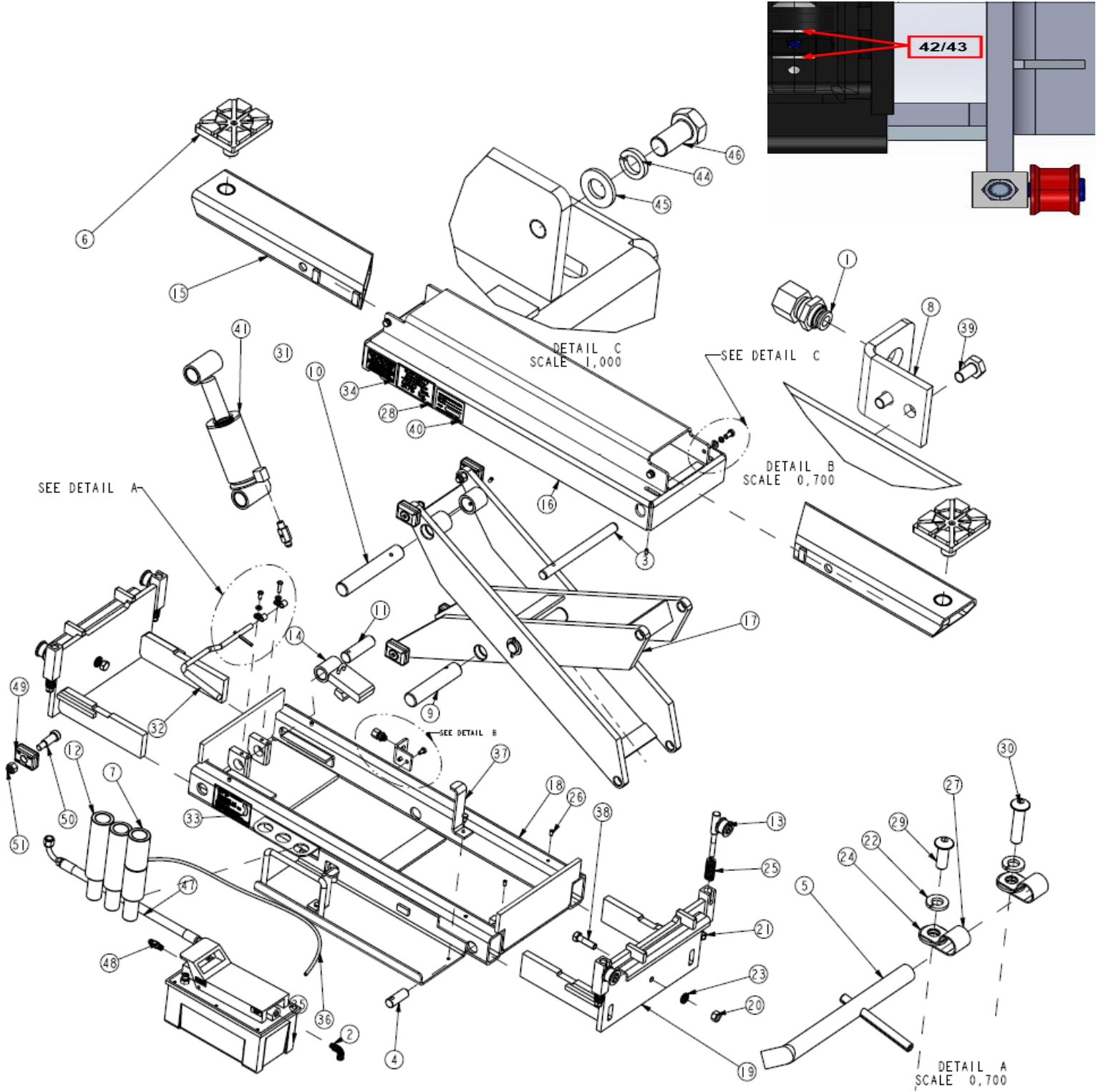

## 12.0 Jack beam Assembly: Parts List

ITEM	QTY.	DESCRIPTION	PART #
1	1	12K SCISSOR TERMINAL FITTING M14X1	9-0673
2	1	SWIVEL ELBOW DIA.6 NYLON TUBE 1/4 NPT-M	9-0675
3	1	JACKBEAM SCISSOR HINGE PIN	1-1999CN
4	2	JACKBEAM HINGE PIN	1-2361CN
5	1	JACKBEAM SAFETY LEVER WELDMENT	1-3203CN
6	2	STACK PAD ASSEMBLY	1-3278CN
7	2	STACK PAD ADAPTER 3 1/4"	1-3280CN
8	1	4-POST / JACKBEAM AIR JACK BRACKET	1-4006CN
9	1	7K JACKBEAM CYLINDER SHAFT LOWER	1-4049CN
10	1	7K JACKBEAM CYLINDER SHAFT UPPER	1-4050CN
11	1	7K JACKBEAM SAFETY PIN	1-4051CN
12	2	STACK PAD ADAPTER 6"	2-1580CN
13	4	JACKING BEAM ROLLER ASSEMBLY	2-2777CN
14	1	7K JACKBEAM SAFETY WELDMENT	2-2951CN
15	2	7K JACKBEAM ARM WELDMENT	2-2953CN
16	1	ECONO JACKBEAM TOP COVER WELDMENT	3-1112CN
17	1	7K JACKBEAM SCISSOR ASS'Y	3-1124CN
18	1	ADJUSTABLE JACKBEAM BASEFRAME WELDMENT	3-1127CN
19	2	7K JACKBEAM ROLLER WELDMENT	3-1135CN
20	2	HEX NUT M12 GB/T 41-2000	1-01788A
21	4	NYLON LOCK NUT M10X1 GB/T 889.2-2000, G.R 8	1-09788A
22	2	SPRING WASHER, 6 GB/T 93-1987	1-04588A
23	2	SPRING WASHER, 12 GB/T 93-1987	1-01688A
24	2	FLAT WASHER, 6 GB/T 95-2002	1-04488A
25	4	JACKBEAM SPRING, 19X50.8	6-0081-MS
26	13	SET SCREW M6x12 GB/T 78-2007 45H	1-09488A
27	2	JACKBEAM LOOP CLAMP, 10	6-3959CN
28	1	CAPACITY DECAL 7000 LBS	6-1994
29	1	HEX.SBHS M6x16 GB/T70.2-2008, G.R 8.8	1-09288A
30	1	HEX. SBHS M6x25 GB/T70.2-2008, G.R 8.8	1-09388A
31	1	JACKBEAM FLOW RESTRICTOR	6-3861CN
32	1	5K JACKBEAM RUBBER GRIP HANDLE	6-3862CN
33	1	5K JACKBEAM DECAL, SAFETY RELEASE	6-3863
34	1	JACKING BEAM RAISE OR LOWER WARNING DECAL	6-3970
35	1	JACK BEAM AIR/HYDRAULIC PUMP	9-0452CN
36	1	AIR TUBE DIA. 6MM	9-0622CN
37	2	BRACKET HYDRAULIC PUMP MOUNTING	9-0666CN
38	2	HEX HD BOLT M12x45 GB/T 5781-2000	1-09888A
39	4	HEX HD BOLT M6x12 GB/T 5781-2000	1-09188A
40	1	SERIAL NO. MODEL NUMBER DECAL	SERIAL_N
41	1	5/7K CYLINDER	9-0515-MS
42	2	ADJUSTMENT WASHER	LY2_1_4_14

43	2	ADJUSTMENT SPACER	9-SF020V
44	4	D8 SPRING WASHER GB/T93-1987	9-0105
45	4	FLAT WASHER $\phi$ 8 GB/T95-2002	1-00688A
46	4	HEX.HD BOLT M8X16GB/T5783-2000 GR 8.8	1-09088A
47	1	HYDRAULIC HOSE ASSEMBLY	1-4063CN
48	1	STRAIGHT UNION 3/8"NPT/JIC-06	9-0558CN
49	4	SLIDER BLOCK W/C'BORE	1-3674CN
50	4	SHOULDER BOLT, $\phi$ 16x32, ISO7379	1-12688A
51	4	NYLON LOCK NUT, M12x1.5 GR 8, GB/T889.2-2000	1-09688A





