



Wheel Balancing Solution

VPI System I
Wheel Balancer

John Bean[®]

Fast, Durable, Accurate

The VPI System I wheel balancer combines cutting-edge technology with a small footprint - perfect for shops where space-saving equipment is a necessity.

John Bean's VPI System I Wheel Balancer will enable your shop to:

- Save time.
- Reduce comebacks.
- Handle a wide range of high-performance/aftermarket wheels.
- **MAKE MORE MONEY!**



VPI System I
EEWB504D

VPI™ Technology - Ultimate Precision & Durability

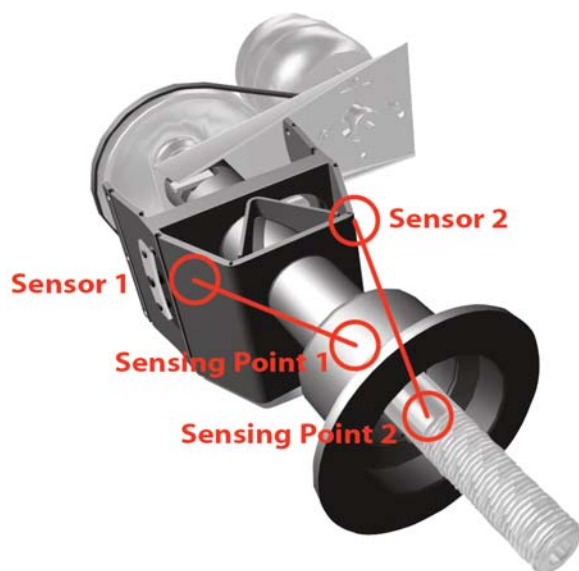

All John Bean balancers feature the industry's best balancing technology - Virtual Plane Imaging (VPI™). Because the wheel and tire assembly is placed between the sensors electronically, VPI™ technology provides unsurpassed measuring accuracy! This configuration physically locates the sensors outside the cabinet - away from internal temperature fluctuations and other stresses.

As a result, VPI Balancers offer the ultimate in precision and repeatability.

Virtual Plane Imaging™ - Proven Technology

During independent research, only the VPI Balancer scored a perfect 100/100 for balancing accuracy!

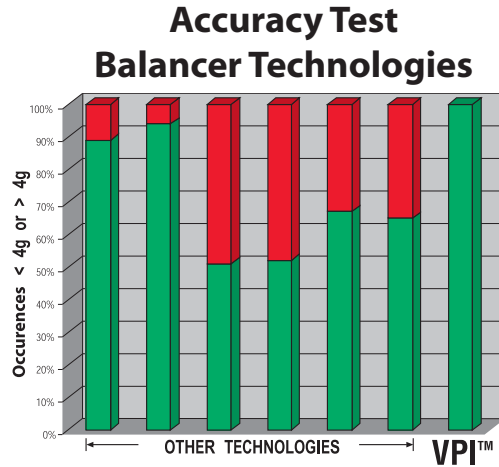

Accuracy Comparisons Using ISO 2953 Standard. Accurate Within 4g Residual Imbalance

Productivity-Enhancing Features

Semi-Automatic Parameter Entry

- Use the inner auto-assist data input arm to quickly and accurately capture wheel distance, and also to place tape weights behind spokes or on the inside edge of the wheel.



Inner Auto-Assist Data Input Arm Measures Wheel Distance.



Inner Auto-Assist Data Input Arm also places tape weights behind spokes or on inner edge of wheel.



Quick-Nut

- Saves time during set-up and take-down.

Multiple Operator Memory

- Allows up to four technicians to work on the same balancer!



Pedal-Activated Spindle Lock

- Keeps wheel locked in place during weight application for accurate placements.

VPI FAMILY SPECIFICATIONS

	VPI System I EEWB504D	VPI System II EEWB503D	VPI System III EEWB502D EEWB502PD
Max. Wheel & Tire Assembly Weight	120 lbs.	133 lbs.	154 lbs.
Max. Wheel & Tire Assembly Diameter	44"	44"	44"
Max. Wheel & Tire Assembly Width	21"	21"	21"
Max. Wheel Diameter	30"	30"	30"
Shaft Diameter	40 mm	40 mm	40 mm
Data Entry	Auto-Assist Data Input Arm (Wheel Distance) & Manual Entry (Wheel Width & Diameter)	Auto-Assist Data Input Arm (Wheel Distance & Diameter) & Manual Entry (Wheel Width)	Auto-Assist Data Input Arms (Wheel Distance, Diameter, & Width)
Power Clamp Configuration	No	No	Yes (EEWB502P)
Quick-Nut Configuration	Yes	Yes	Yes (EEWB502B)
Weight Storage Pockets	13	19	17
Display	Integrated 3-Window LED	Integrated 3-Window LED	Elevated 3-Window LED
Measuring Speed	100 RPM	100 RPM	200 RPM
Balance Accuracy	0.035 oz.	0.035 oz.	0.035 oz.
Footprint	36" x 32"	51" x 48"	60" x 49"
Shipping Weight	315 lbs.	325 lbs.	380 lbs.
Power Requirements*	120V, 1Ph, 60Hz	230V, 1Ph, 60Hz	230V, 1Ph, 60Hz

* Other Power Configurations Available

VPI SYSTEM I ACCESSORIES

Standard

EAC0058D07A	Large pressure cup
EAC0058D08A	Pressure disc
EAM0021D90A	Stub shaft
EAM0005D40A	Calibration weight
EAA0247G21A	Wheel width gauge
EAC0060G02A	Cover hook flange
EAM0006G01A	Storage Pegs
EAA0263G66A	Quick-Nut
EAC0058D15A	Soft Protective Ring

John Bean offers a number of specialty accessory kits with pin plates & special OEM approved collets recommended for specialty aftermarket and OEM clad wheels. For more optional accessories, contact a Local Sales Representative or visit www.snaponequipment.com.

Optional

Because wheel designs are unique and ever-changing, standardized cone packages lack the flexibility to meet the mounting demands of today's wheels. Putting our customer's needs first, John Bean offers a selection of cone packages capable of servicing a wide range of wheel and tire assemblies.

To complete your wheel balancing package, choose from one of these cone kits:

4 Cone Kit

EAK0221J60A (2.1" to 5.2")



7 Cone Kit

EAK0221J31A (1.7" to 6.3")



Check out our accessory brochure for more productivity-enhancing accessories!

Snap-on Equipment / 309 Exchange Avenue / Conway, Arkansas 72032 U.S.A.
Fax: 501-450-2085 / Toll Free: 1-800-362-4618 / International: 501-450-1568
www.snaponequipment.com/johnbean

John Bean Canada / 6500 Millcreek Drive / Mississauga, Ontario L5N 2W6
Customer Service: 1-800-362-4608 / Fax: 905-826-7800
www.johnbean.ca